

Seating information for Individuals with Disabilities

All theaters at MACC are wheelchair accessible. Wheelchair accessible restrooms, both male & female, are available in Yokouchi Founders' Court, off the McCoy Courtyard, and on Castle Theater Lobby level.

For events in the Castle Theater:

The wheelchair seating access for the Castle Theater is on Orchestra level; there is a wheelchair-accessible elevator to other levels. See map next page for a sample seat map. Please note that although we try for consistency, IWD seating may not always be available 'in the same place as the last show.'

For events in the McCoy Studio Theater:

Wheelchair patrons can be accommodated on the main floor of the theater at house right, front row, unless the specific event requires a "theater in the round" set-up in which case the seating would be made on an individual case-by-case accommodation. The entrance is on ground level, van and wheelchair accessible from the front drive and 'blue' curb' parking spots. There are accessible restrooms, male and female, near the entrance of the theater doors.

For events in the A & B amphitheater:

Please be aware that outdoor concerts take place rain or shine on a grassy lawn, fitted with temporary seating (chairs are attached together in rows) and barricades erected for the safety and technical and code requirements of the organization, artists and configuration of audience in mind.

For large amphitheater shows, increased parking is created for IWD patrons, and the parking lot is Van Accessible for easy entrance near the front gates, with ramped curbs. Also, there are marked IWD Toilets in several locations, positioned as best as possible for accessibility.

Seating accommodations can be made for Individuals With Disabilities (IWD) and we are happy to help each individual as best we can ...but there are some factors beyond our control:

- ◆ Weather conditions. Outdoor concerts tickets are sold for all patrons with the caveat "Rain or Shine." Maui is fortunate to have some of the most pleasant and constant year-round weather. Storms happen, however, and unless there are unsafe assembly conditions, the show goes on in spite of rain, sun or wind. Although there is a covered sidewalk arcade along one side of the amphitheater lawn from the front entrance gates, which can be used by IWD and able-bodied patrons in rainy weather, there is no covered, temperature controlled environment available for outdoor concerts. IWD patrons should be aware that they will experience the same natural elements experienced by all other patrons. For the most part, amphitheater events go forward rain or shine, as is printed on the tickets.

- ◆ Show set-up. Each event in the A & B Amphitheater is show-specific: sometimes there are assigned seats; sometimes the show is 'general admission' i.e. no assigned seats, lawn & bleacher seating only; sometimes the show is a combination of those two set-ups; sometimes the event is dining-style tables and chairs. IWD patrons should inquire about the set-up of each show as a separate event, not necessarily based on the previous experience.

- ◆ Technical requirements of each specific show may vary, changing the location of sightlines and spaces available for IWD seating. Some of the factors in play include light towers, speaker positioning, etc... all items we try to keep in mind for the safety, comfort and enjoyability of the show of our IWD patrons.

- ◆ An unobstructed viewing platform is usually erected to the house left for IWD, with a direct sightline to the stage. Another frequent location is near the stage, to the house left... always at the end of seat rows since seats cannot be de-attached and re-attached in amphitheater set-up, and for the ultimate safety of the individual with disability if the need arises for quick, orderly exit.

- ◆ The Box Office Manager will be happy to assist with pre-planning for IWD attendance at any specific event, although please be aware that answers to some questions may not be available until the exact technical requirements for any individual show has been set by the artist – sometimes even within the week of the event. Although we try for consistency, IWD seating may not always be available 'in the same place as the last show.'

Additional Notes and Services:

- Again, the Box Office Manager and the House/Event Manager will be happy to assist with planning for IWD attendance at any specific event, and see to it that each person is accommodated to the best of our abilities. When notified in advance, special assistance by our Volunteer Usher Staff can be arranged for any event.
- Audio devices are available for Castle Theatre Events to assist hearing, see House Manager upon arrival to theatre or alert any usher to your need.
- We accommodate trained licensed Seeing Eye and disability assistant companion animals to all events.
- We do not have control over sight limitations in the event a performer may ask or encourage audiences to stand, cheer, sing or dance.

For more information & personal assistance — ask the Box Office Staff!

call: 808-242-7469 (Mon-Sat 10 am - 6 pm)

email: boxoffice@mauiarts.org • fax: 808-244-8850.

Maui Arts & Cultural Center

One Cameron Way • Kahului, HI 96732 • 808-242-2787 • www.MauiArts.org

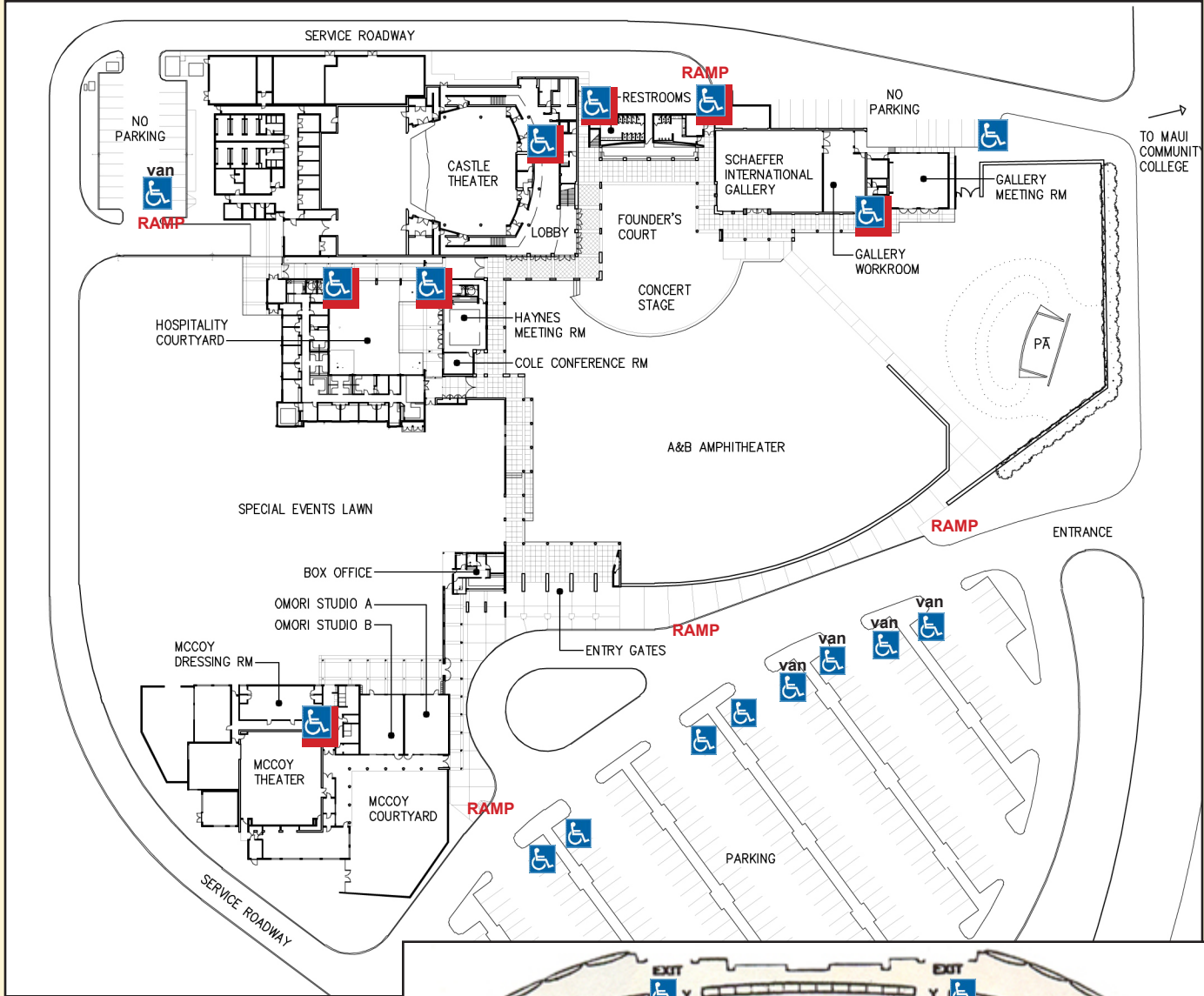

MACC Site Map
Restrooms, Ramps & Parking Areas
marked for accessibility:

PARKING:  & 

RESTROOM: 

Castle Theater
Ground Floor - Orchestra Level
accessible seat options
marked with  (as available)

